



## Recommendations for the user



It is common for the first use of the grill to give off a smell of burnt paint. This is normal and part of the curing process, it will not occur in the future.



Remember not to touch any metallic surfaces while the grill is in use; it could cause severe burns.



The use of excessive embers on your grill can deteriorate it over time. This happens due to a by-product of the combustion process that deteriorates the metal sheet.



Be sure to store your grill in a dry place to prevent rusting.

# COWBOY Grill

## Assembly instructions



# Congratulations!

## Your grill has just arrived

### Safety warnings

- Do not use your grill indoors, it should only be used outdoors. Otherwise, it may cause serious poisoning by smoke inhalation, fire or deterioration.
- Do not leave infants, children, or pets unattended nearby a lit grill.
- Do not add lighter fluid or any type of inflammable fuel
- Proceed with care when using your grill, it will maintain high temperatures.
- Do not remove the ashes until the charcoal is completely blown out and the grill is cold
- The use of abrasive cleaners on the grill or on the accessories may damage the surfaces.
- The grill should be cleaned regularly to remove ash to prevent deterioration of the surfaces.

### General Dimensions

Dimensions in mm / inches

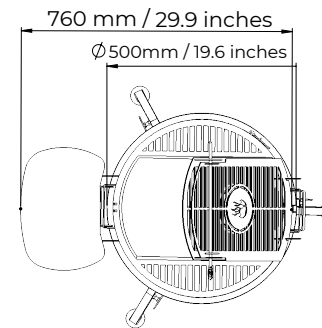
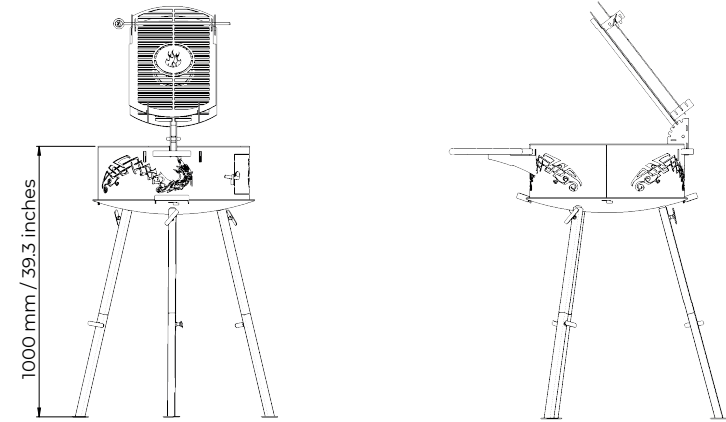

### Packaging dimensions

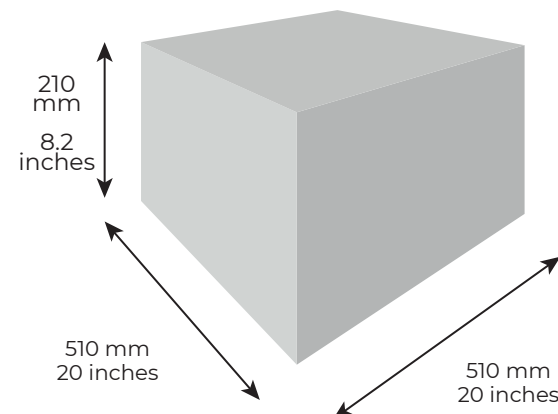

### WEIGHTS



Grill weight

**22 kg**

**48.5 pounds**



Weight with packaging

**24 kg**

**52.9 pounds**



## Component parts

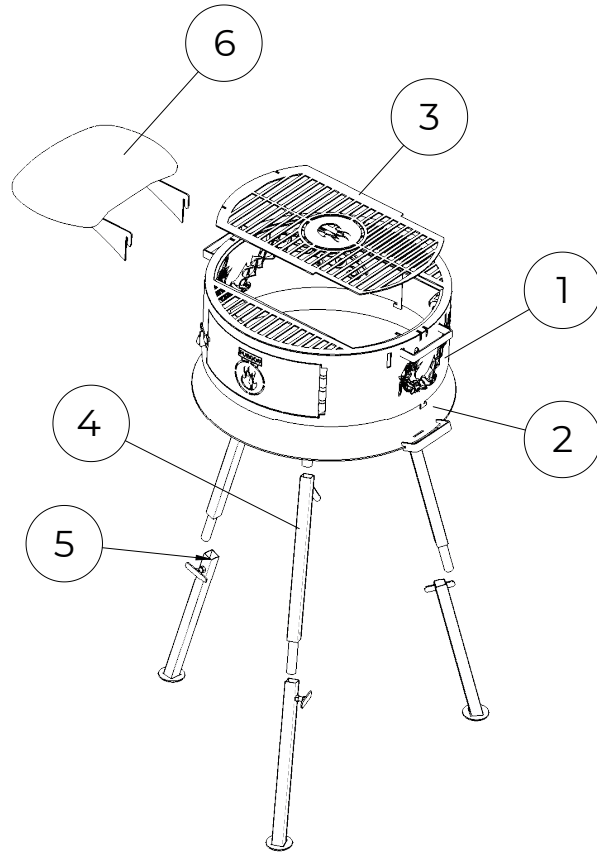

Part	Name	Qty
1	Main body	1
2	Disc	1
3	Individual grill	1
4	Top Leg	3
5	Base Leg	3
6	Wooden surface	1

## Accessories included

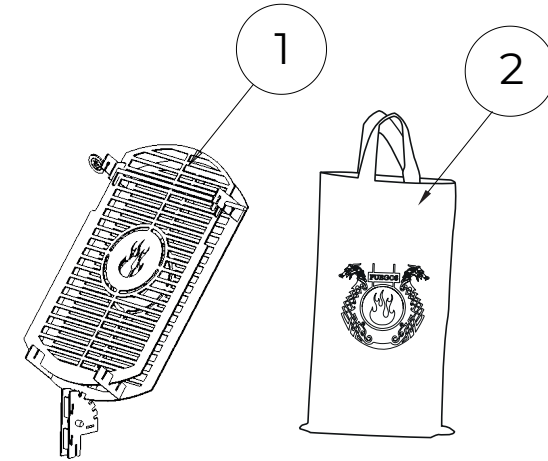

Part	Name	Qty
1	Clamp rack grill	1
2	Cover	1

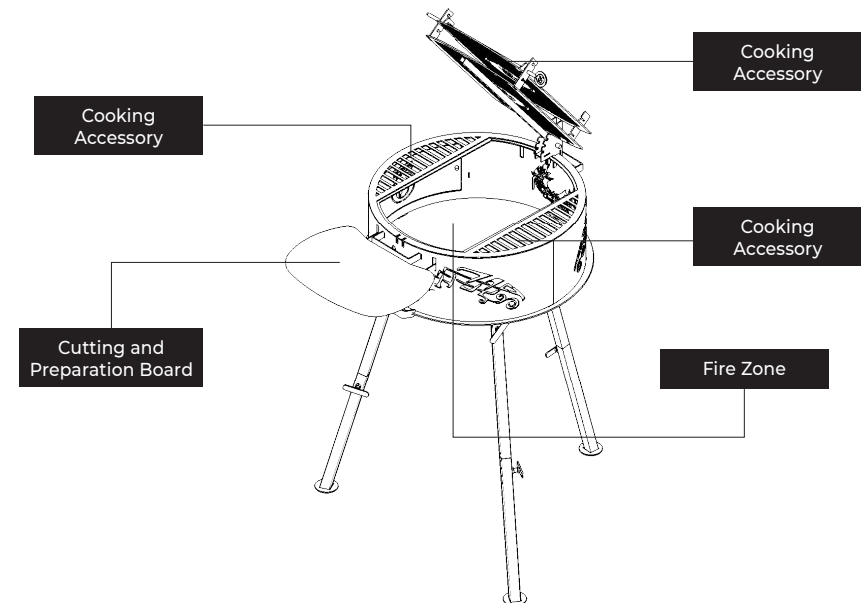

# Assembly instructions

**Step 1:** Before starting the assembly, separate the disc from the main body. To do this, turn the disc clockwise and remove it upwards.

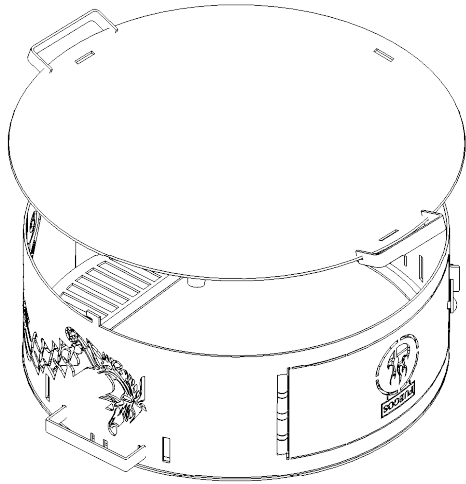

**Step 2:** Place the disc with the tubes facing upwards.

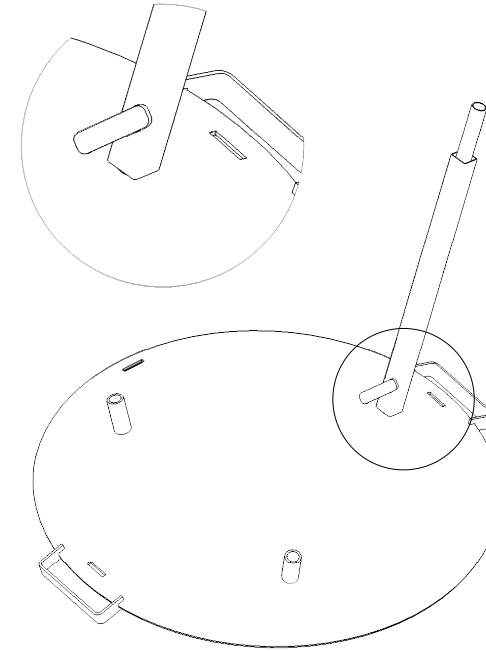
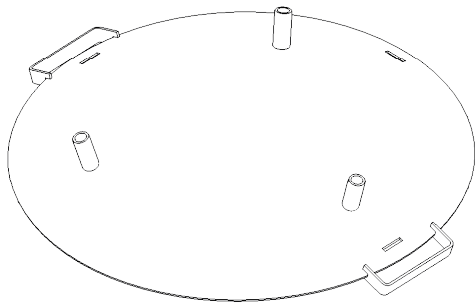

**Step 3:** Position the top legs of the grill and use the cranks to adjust them.

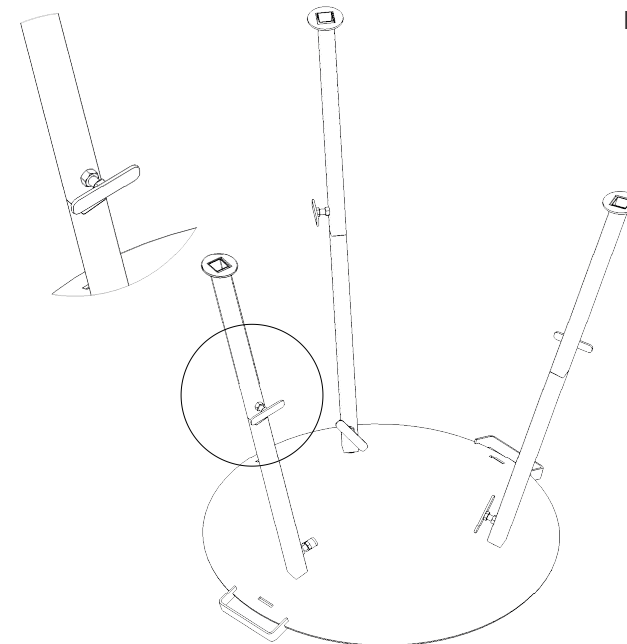

**Step 4:** Place the base legs on top of the top legs and adjust with the cranks.

## Assembly of accesories

**Step 5:** Rotate the structure again, support it on its legs.

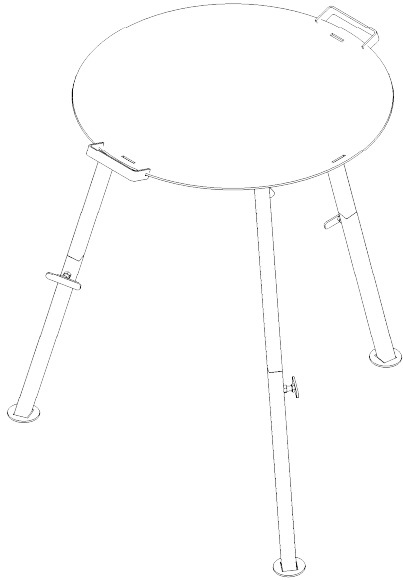

**Step 6:** Place the main body by resting it on the disc and then turning clockwise. Once this is done, place the grill or accesories according to the use you are going to give to your grill.

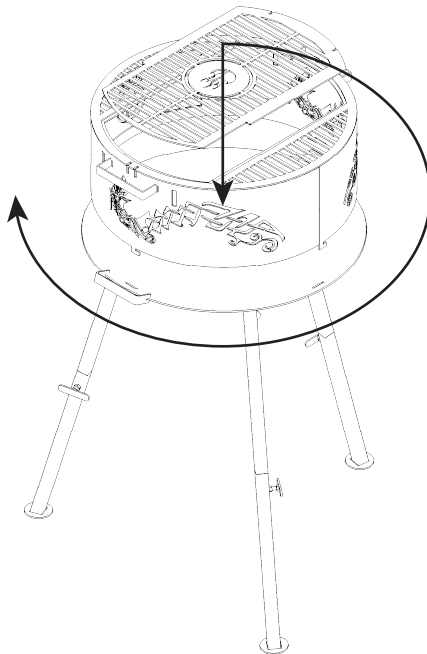

**Step 7:** Once the main body is assembled, place the side boards.

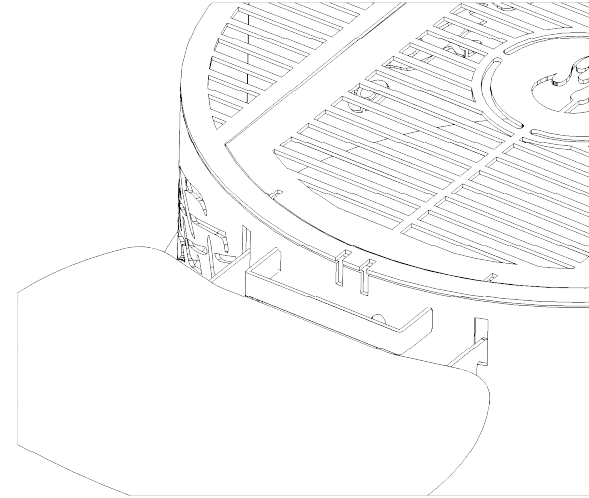

**Step 8:** Place the clamp rack grill accessory by inserting it into the side slots.

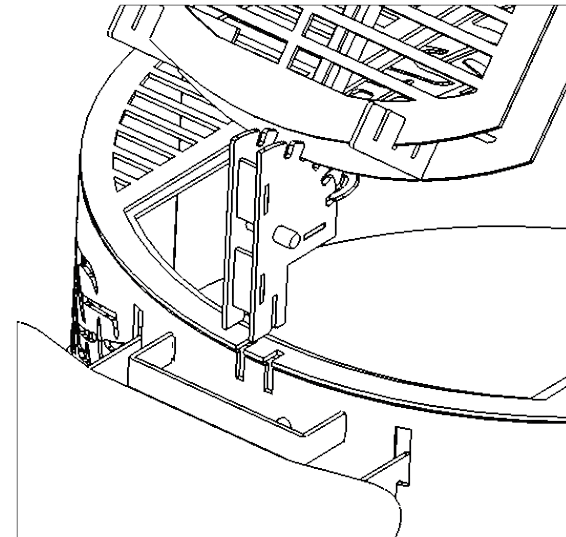

To cook with the clamp rack grill, remove the sword and lift the movable grate. Then place the meat between the gratings, press down and replace the sword.

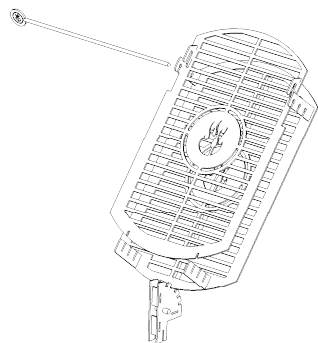

To adjust the position of the clamp rack grill, move the grating up slightly to unlock it, move it to the desired position and lock it again.

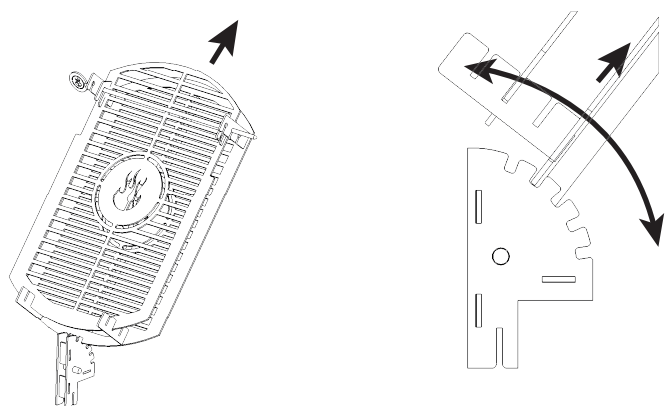

You can adjust the position of the clamp rack grill to achieve a faster or slower cooking of the meat. In this way, you will be able to obtain different cooking points.

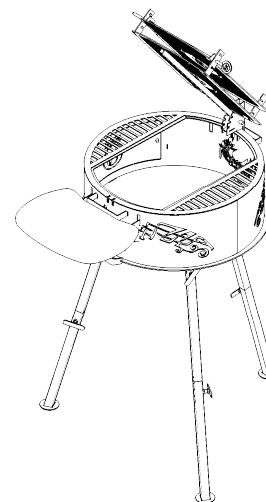
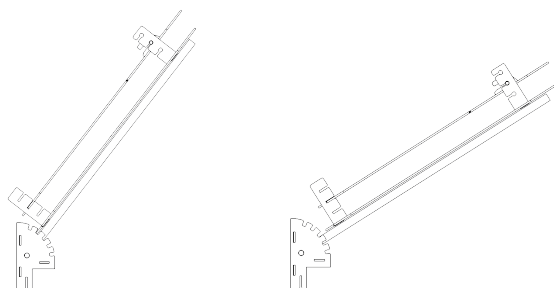

# COWBOY

Check list

Part	Name	Qty
1	Main body	1
2	Disc	1
3	Individual grill	1
4	Top Leg	3
5	Base Leg	3
6	Wooden surface	1

Part	Name	Qty
1	Clamp rack grill	1
2	Cover	1

Part	Name	Qty
1	Assembly manual	1